

**START HERE...**

Verify contents; inspect for damage.

- A - (4) Legs
- B - Remote Control
- C - (3) AAA Batteries
- D - Remote control holder (shown holding remote control)
- E - Power Supply (includes power brick, electrical feed cord, and electrical power cord)
- F - (2) USB Charging Stations (factory attached at head end of base for most sizes; included in hardware box with self-adhesive buttons for Split Queen sizes)
- G - Dual Sync Cable (split sizes only)
- H - Owners Manual
- I - Warranty Activation Card
- J - Mattress Retainer (cut zip-tie to remove)

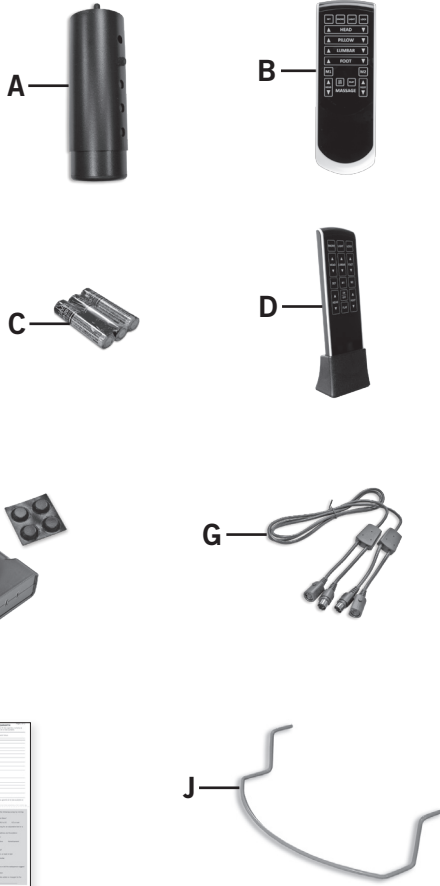

READ ALL INSTRUCTIONS BEFORE USING

**WARNING**

DUE TO RISK OF INJURY, TWO ADULTS ARE REQUIRED TO HANDLE AND MOVE ADJUSTABLE BASE.

- 1 EXTEND POWER CORD OUT HEAD END OF BASE.  
*Note: Power cords must not interfere with any adjustable base mechanisms. Do not weave cords through base structure.*  
REMOVE HARDWARE BOX. CUT ZIP-TIE AND REMOVE MATTRESS RETAINER.  
SCREW LEGS INTO BASE FRAME.

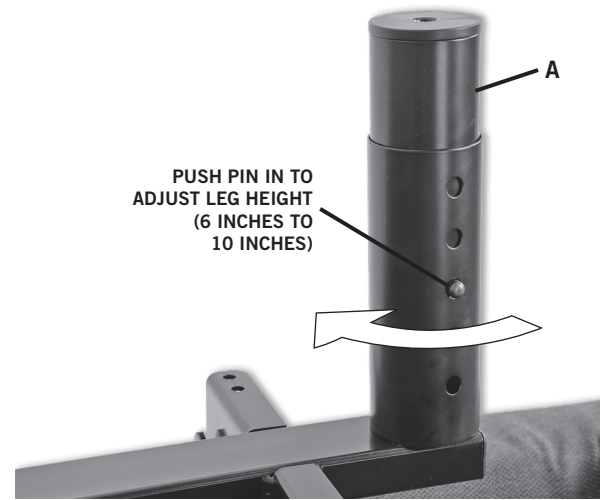

- 2 ROTATE BASE OVER SO IT IS RESTING ON ITS LEGS.  
NOTE THE USB CHARGING STATIONS AT HEAD END OF BASE.

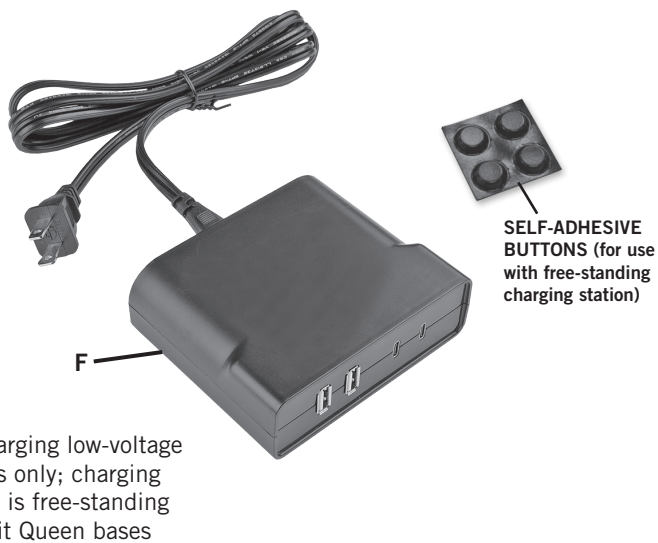

- 3 PLUG BASE INTO ELECTRICAL POWER SOURCE.  
INSTALL BATTERIES IN REMOTE CONTROL (3-AAA SIZE, INCLUDED).

Remove battery compartment door by lifting tab. Insert tab in slots and snap in to replace.

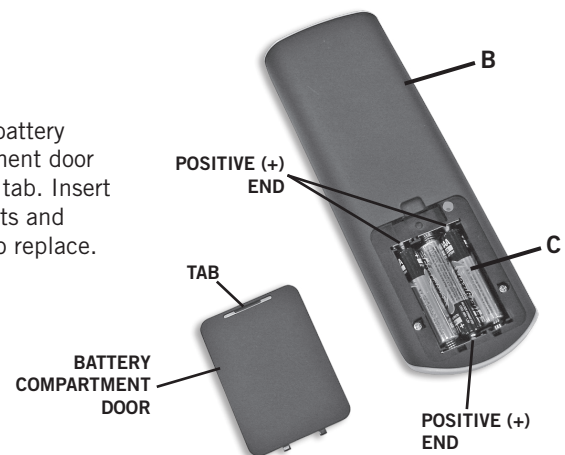

OPERATE REMOTE CONTROL TO VERIFY BASE FUNCTIONS PROPERLY.  
*Note: When touched, activated button on remote turns blue.*

- 4 OPTIONAL: INSTALL MATTRESS RETAINER. Base is equipped with Micro-Hook™ system, but mattress retainer can be used, if desired.

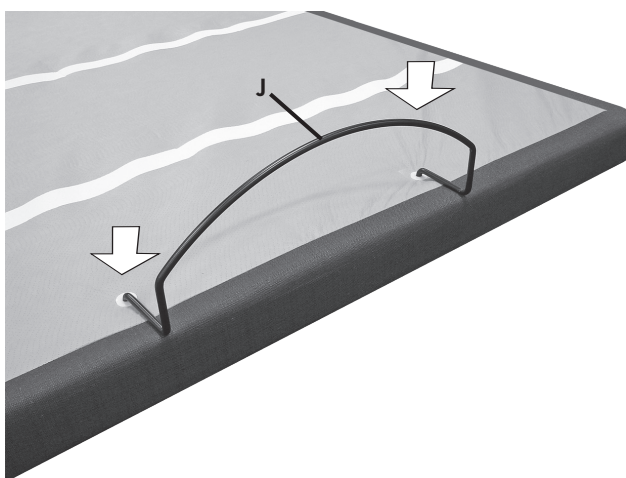

- 5 Install mattress to complete setup.  
If adjustable base will not operate, see Troubleshooting in the owners manual.

